

# 3900 Metal Lever Switches 16A 250Vac



- ▶ Metal lever switches
- ▶ Ratings up to 20A, 277V ac
- ▶ Single and double pole
- ▶ Choice of circuits including 3 position and momentary
- ▶ 6.3mm and solder terminals
- ▶ Guard option



16(4)A 250Vac T85 (3900 & 3950)  
10(4)A 250Vac T85 (All other circuits)

UL CSA 20A 125/277Vac (ON-OFF Circuits)  
UL CSA 16A 125/277Vac (Other Circuits)  
UL CSA 7A 72Vdc, 14A 36Vdc  
UL 250Vac 1hp, 125Vac 1/2hp  
UL 85°C, file E45221, CSA file LR10990

Inrush rating - Contact factory for details



RoHS compliant

Approvals and ratings vary with function.  
3mm contact gap except where marked  $\mu$ .  
Technical data on pages 4 & 5.

**C 3900 B A - - -**

TERMINAL FUNCTION ACTUATOR BODY OPTIONS

TERMINAL	FUNCTION	ACTUATOR	
<p><b>C</b></p> <p>6.3 x 0.8</p>	<p><b>Single pole</b></p>	<p><b>B</b></p> <p>17.5</p> <p>Finish is nickel plate.</p>	
<p><b>T</b></p> <p>10.5</p> <p>3.1</p> <p>Solder</p>	<p><b>Double pole</b></p>		
	<p><b>3900</b></p> <p>ON - OFF</p>		<p><b>3950</b></p>
	<p><b>3901</b></p> <p>ON - OFF (momentary ON)</p>		<p><b>3951</b></p>
	<p><b>3902</b></p> <p>ON - OFF (momentary OFF)</p>		<p><b>3952</b></p>
	<p><b>3910</b></p> <p>ON - ON</p>		<p><b>3960</b></p>
	<p><b>3911</b></p> <p>ON - ON (momentary 1 side)</p>		<p><b>3961</b></p>
	<p><b>3920</b></p> <p>ON - OFF - ON <math>\mu</math></p>		<p><b>3970</b></p>
	<p><b>3921</b></p> <p>ON - OFF - ON <math>\mu</math> (momentary 1 side)</p>		<p><b>3971</b></p>
	<p><b>3922</b></p> <p>ON - OFF - ON <math>\mu</math> (momentary 2 sides)</p>		<p><b>3972</b></p>



C3900BA ---



C3920BA ---



**Guard R17-10**  
Anti-rotation tab can be specified for guard fitted in On or Off position



C3950BB ---



C3972BB ---

**BODY**

**A**  
Without terminal barrier  
Single pole

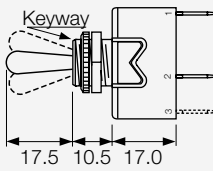

**B**  
With terminal barrier  
Double pole only

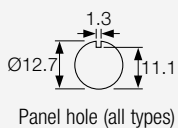
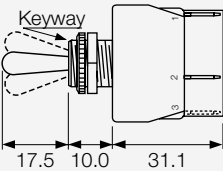

**OPTIONS**

**Neck Seal M539**  
Actuator is visible



**Cover M1080**



Covers have internal nylon nuts

**Fixing nuts**  
Nickel plated brass are supplied

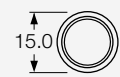
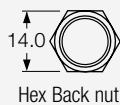

Panel thickness 4.0 with backnut

**DIMENSIONS** (mm) \* Indicates ON position (for ON - OFF switches)

**Single Pole**  
(C terminals shown)

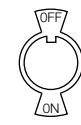
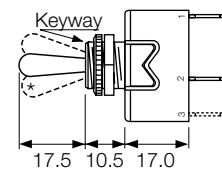
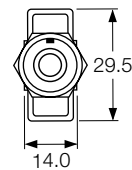

Optional  
P232 plate  
SP or DP

**Double Pole**  
(C terminals shown)

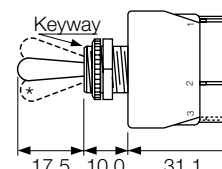
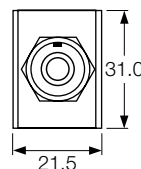

# 1700 & 1750 Lever Switches

16A 250Vac Single and Double Pole



- ▶ Nylon lever switches
- ▶ Ratings up to 20A, 250V ac
- ▶ Single and double pole
- ▶ Wide choice of terminals
- ▶ Choice of circuit options including 3 position
- ▶ Flat & round lever profiles



16(4)A 250Vac T85



UL 20A 250Vac Non Ind (Single pole)  
 UL 16A 250Vac Non Ind (Double pole)  
 UL CSA (2 pos types) 250Vac 1hp, 125Vac 1/2hp  
 UL CSA (3 pos types) 250Vac 1/2hp, 125Vac 1/4hp  
 CSA 16A 250Vac Non Ind  
 UL 85°C, file E45221, CSA file LR10990  
 UL and CSA N/A on momentary types

In house test

Inrush 36A to EN61058-1 & 20A 28Vdc



RoHS compliant

Selective "A, B, C" and "OFF, A, A+B" circuits at 5 amp also available.  
 3mm contact gap except where marked  $\mu$ .  
 Technical data on pages 4 & 5.

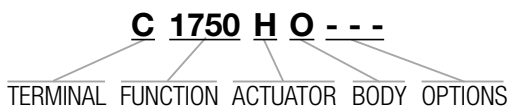

TERMINAL	FUNCTION		ACTUATOR
<b>C</b>  6.3 x 0.8	<b>Single pole</b>  <b>1700</b>  ON - OFF	<b>Double pole</b>  <b>1750</b>  ON - OFF	<b>H</b>  16.4
<b>H</b>  4.8 x 0.8	<b>1710 <math>\mu</math></b>  ON - ON	<b>1760 <math>\mu</math></b>  ON - ON	
<b>K</b>  2.8 x 0.8	<b>1720 <math>\mu</math></b>  ON - OFF - ON	<b>1770 <math>\mu</math></b>  ON - OFF - ON	<b>R</b>  13.8
<b>T</b>  Solder	<b>1721 <math>\mu</math></b>  ON - OFF - ON (momentary 1 side)		
<b>X</b>  PCB 0.8 Sq	<b>1722 <math>\mu</math></b>  ON - OFF - ON (momentary 2 sides)		The switch is on between centre terminals (2 & 5) and the terminals over which the lever is positioned.



C1700RO ---



C1700HO ---



C1760RO ---



C1750HO ---

**BODY**

**0**  
Single pole

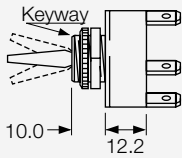

**0**  
Double pole

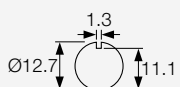
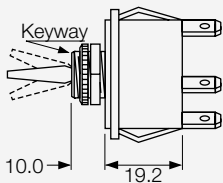

Panel hole (all types)  
Panel thickness (Max)  
Both nuts - 3.5mm  
Less backnut - 6.5mm

**OPTIONS**

**Neck Seal M539**  
Material - Nitrile  
(H & R Actuators)  
Actuator visible



**Cover M1080**  
Material - EPDM  
(R Actuator only)



**Cover M331**  
Material - PVC  
(R Actuator only)



Covers have internal nylon nuts

**Fixing nuts** (Standard is M506 & T92)  
T5 Hex brass  
M506 Hex nylon

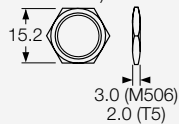

T92 Knurled brass

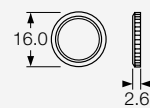

M279 Knurled nylon

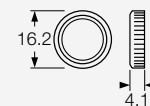

**DIMENSIONS (mm)**

**Single Pole**  
(C terminals shown)

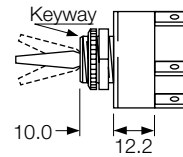
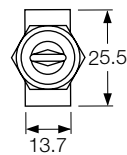

Optional  
P232 plate  
SP or DP

**Double Pole**  
(C terminals shown)

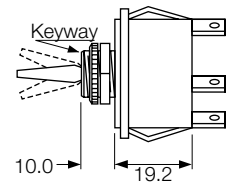
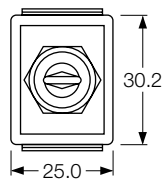

Optional terminal barrier M441 is available.

# 0600 Lever Switches 1A 250Vac



C0600HD - - - C0600CC - - -



C0602SC - - -

- ▶ Lever switch
- ▶ Brass and nylon actuators
- ▶ Single pole
- ▶ Latching and momentary action
- ▶ Choice of actuator profiles

**In house test**

**1A 250Vac**

**RoHS**

**RoHS compliant**

3mm contact gap.  
Technical data on pages 4 & 5.

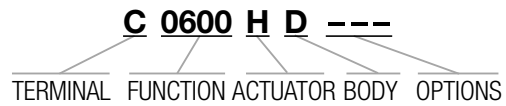

▶ TERMINAL	▶ FUNCTION	▶ ACTUATOR	▶ BODY	▶ OPTIONS
<p><b>C</b></p> <p>6.3 x 0.8 10.1</p>	<p><b>0600</b></p> <p>ON - OFF</p> <p><b>0602</b></p> <p>ON - OFF (momentary ON)</p>	<p><b>C</b> Chromed brass (0600)</p> <p>15.0</p> <p><b>U</b> Nylon (0600)</p> <p>12.1</p> <p><b>G</b> Nylon (0600)</p> <p>27.0</p> <p><b>H</b> Nylon (0600)</p> <p>17.0</p> <p><b>S</b> Chromed brass stem/ nylon paddle (0602 only)</p> <p>41.8</p>	<p><b>D</b> Nylon neck and top plate (Used with actuator codes U, G and H)</p> <p><b>C</b> Metal neck and top plate (Used with actuator codes C and S)</p> <p>1.3 11.1 Ø12.7</p> <p>Panel thickness - 3.5mm Back nut must be fitted</p> <p><b>Fixing nuts</b> (Standard is M506 &amp; T92)</p> <p><b>T5</b> Hex brass <b>M506</b> Hex nylon</p> <p>15.2 3.0 (M506) 2.0 (T5)</p> <p><b>T92</b> Knurled brass</p> <p>16.0 2.6</p> <p><b>M279</b> Knurled nylon</p> <p>16.2 4.1</p>	<p><b>Cover M331</b> (C Actuator only)</p> <p><b>Seal M539</b> (C,H &amp; U Actuators) Actuator visible</p> <p><b>Cover M1080</b> (C Actuator only)</p> <p>Covers have internal nylon nuts.</p>

**Dimensions (mm)**

**0600** (U actuator shown)

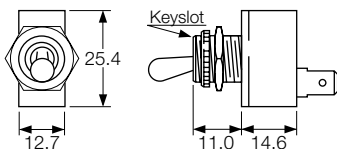

**0602**

